



FOR LEASE

24,000 SF RETAIL ANCHOR SPACE DIVIDABLE **4 WASHINGTON ST., CANTON, MA** *At Cobb Corner across from Village Shoppes of Canton*

AVAILABLE:

24,000 SF Anchor Space adjacent to Washington St. & Rt. 27 Intersection

High-Traffic, High-Volume Location at Canton/Sharon/Stoughton Line

FEATURES:

- 24,000 SF with 2 designated dock doors
- Open floor plan with 21' ceiling height
- Additional parking proposed totaling 247 spaces
- Excellent visibility and signage with premium pylon
- Traffic: Washington St. - 20,201 ADT
- Join co-tenants Pediatric Associates, Stone L'Oven Pizza, Roberts Jewelry, The Fit Bodi, Visions Salon, Postal Center USA, Anton's Cleaners, Blinds & Designs and Dunkin Donuts!





Information presented herein is from sources deemed reliable. However, no warranty can be made as to the accuracy of this information, which is presented subject to prior sale, rental, or withdrawal from the market without notice.

COBB CORNER PLAZA



Demographics

	Total Population		
	2 Mile	5 Mile	10 Mile
	26,770	118,647	578,050
	Median HH Income		
	2 Mile	5 Mile	10 Mile
	\$128,672	\$133,413	\$124,842

CONTACT:

Bobby Burke
508-479-5294
bobby.acreco@gmail.com



FOR LEASE

24,000 SF RETAIL SPACE Anchor Box with Docks (Sub-dividable)

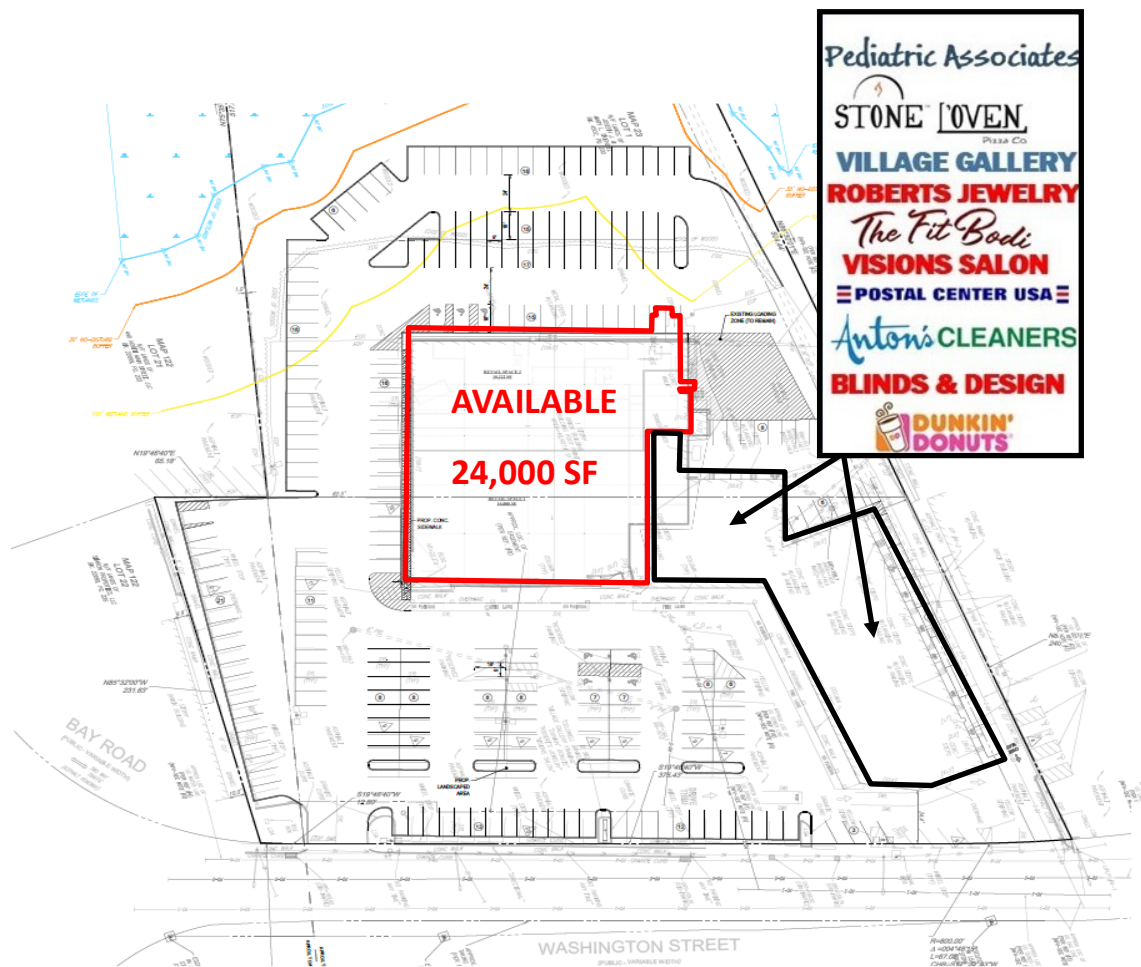

CONTACT:

Bobby Burke
508-479-5294
bobby.acreco@gmail.com



AMERICAN COMMERCIAL REAL ESTATE
50 LEDGEVIEW WAY #2415, WRENTHAM, MASSACHUSETTS 02093
TEL: (508) 735-6378 | FAX: (508) 861-0537 | E-MAIL: dusty@acreco.com | www.acreco.com



FOR LEASE

Conceptual façade upgrade (for entire center)

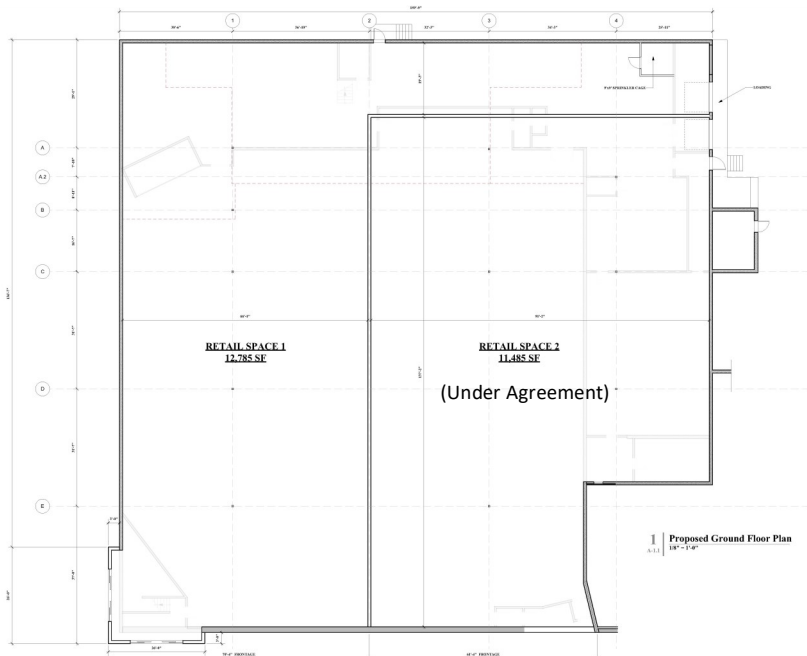

CONTACT:

Bobby Burke
508-479-5294
bobby.acreco@gmail.com



AMERICAN COMMERCIAL REAL ESTATE
50 LEDGEVIEW WAY #2415, WRENTHAM, MASSACHUSETTS 02093
TEL: (508) 735-6378 | FAX: (508) 861-0537 | E-MAIL: dusty@acreco.com | www.acreco.com