



1010 MORRISSEY BLVD.  
DORCHESTER, MA

AMERICAN COMMERCIAL REAL ESTATE

2,732 SF ENDCAP  
Outstanding Location For Lease  
1010 Morrissey Blvd., DORCHESTER, MA



*Contact:*

*Dusty Burke [dusty@acreco.com](mailto:dusty@acreco.com)  
508-735-6378*

AMERICAN COMMERCIAL  
REAL ESTATE

50 Ledgeview Way, #2415  
Wrentham, MA 02093  
[www.acreco.com](http://www.acreco.com)

- 1010 Morrissey Blvd., Commuter Rail and Southeast Expressway at rear of site
- Concept: former Boston Market. Join City of Boston Credit Union and Supercuts
- Available: 2,732 SF, approx. 50' X 60'
- Great storefront and pylon signage
- Outstanding visibility on Morrissey Blvd., with ample parking
- Traffic: 16,215 Morrissey Blvd.; 184,000 Southeast Expressway
- Demos:

DEMOGRAPHICS	1-MILE	3-MILE	5-MILE
POPULATION	23,945	217,893	512,425
HOUSING UNITS	10,954	89,914	228,538
MEDIAN INCOME	\$68,353	\$66,009	\$65,601





1010 MORRISSEY BLVD.  
DORCHESTER, MA

AMERICAN COMMERCIAL REAL ESTATE

2,732 SF ENDCAP  
Outstanding Location For Lease  
1010 Morrissey Blvd., DORCHESTER, MA



*Contact*

*Dusty Burke [dusty@acreco.com](mailto:dusty@acreco.com)  
508-735-6378*

**AMERICAN COMMERCIAL  
REAL ESTATE**

50 Ledgeview Way, #2415  
Wrentham, MA 02093  
[www.acreco.com](http://www.acreco.com)





1010 MORRISSEY BLVD.  
DORCHESTER, MA

AMERICAN COMMERCIAL REAL ESTATE

# 2,732 SF ENDCAP

## Outstanding Location For Lease

### 1010 Morrissey Blvd., DORCHESTER, MA

#### Existing Floor Plan

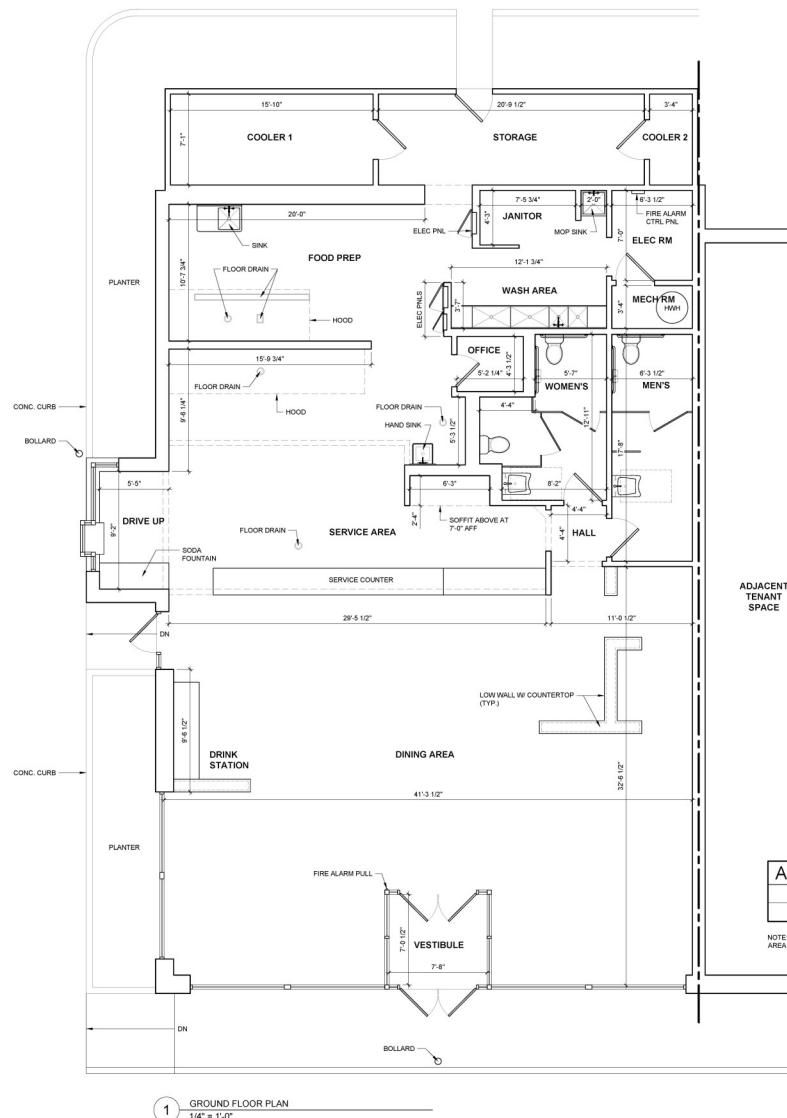

Area Calculations	
NSF	GSF
2,458	2,732

NOTE: BACK COOLERS AND STORAGE AREA ARE EXCLUDED FROM AREA CALCULATIONS.

1 GROUND FLOOR PLAN  
1/4" = 1'-0"

#### Contact

Dusty Burke [dusty@acrecos.com](mailto:dusty@acrecos.com)  
508-735-6378

AMERICAN COMMERCIAL  
REAL ESTATE

50 Ledgeview Way, #2415  
Wrentham, MA 02093  
[www.acrecos.com](http://www.acrecos.com)