



FOR LEASE

NEW RETAIL UNDER CONSTRUCTION **Join Starbucks, Burger King, YATCO & Gulf** **Leicester Commons, RT 9, Opposite Walmart** **1603-1621 Main St, Leicester, MA 01524**

Concept:

- State of the Art Retail Center of 3 buildings totaling 13,500 SF including YATCO Convenience Center, Starbucks, Burger King, Gulf Gas, and EV charging stations.

Available:

- 1,500 SF Endcap, next to Starbucks
- 5,100 SF Free-standing, w/ Drive Thru, Dividable
- Now Under Construction
- Full Utilities
- Autumn 2023 Opening
- Traffic: Main St. - 16,148 ADT
- Demos:

	2-Mi.	5-Mi.	10-Mi.
Population	5,191	47,833	298,452
Avg. HH Income	\$101,508	\$98,624	\$88,428

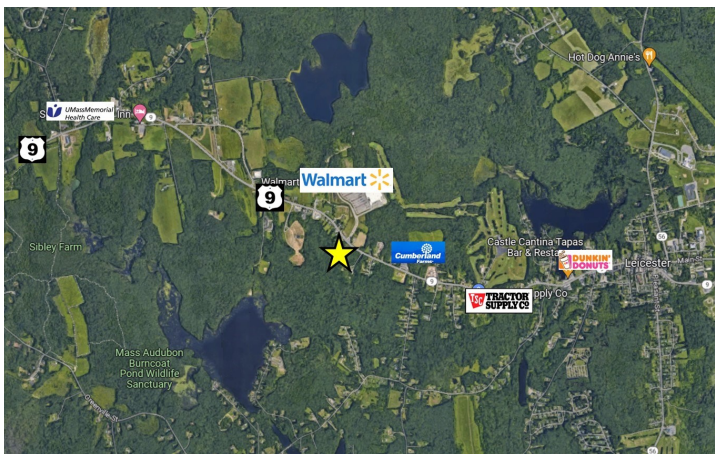
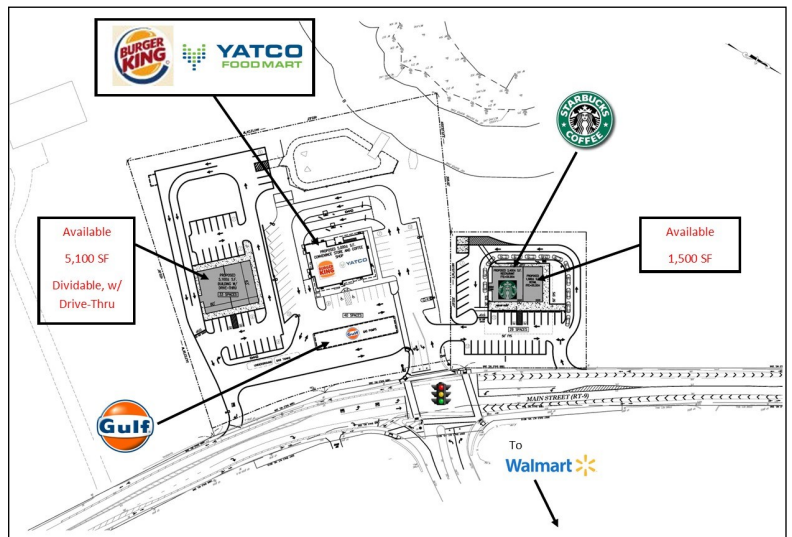

For more information, contact:



Dusty Burke
508-735-6378
dusty@acresco.com



Dusty Burke III
508-735-5976
dusty3@acresco.com



AMERICAN COMMERCIAL REAL ESTATE
50 LEDGEVIEW WAY #2415, WRENTHAM, MASSACHUSETTS 02093

TEL: (508) 735-6378 | FAX: (508) 861-0537 | E-MAIL: dusty@acresco.com | www.acresco.com

Information presented herein is from sources deemed reliable. However, no warranty can be made as to the accuracy of this information, which is presented subject to prior sale, rental, or withdrawal from the market without notice.