

High-Profile Retail Endcap at Apex Center

Boston Post Rd. West, Marlborough, MA

Between Apex Entertainment Center and Chick-fil-A

5,000 SF Available



Now Available

5,000 SF is now available at the Apex Center, New England's world class entertainment, fitness, and hospitality hub. Positioned immediately next to Apex Entertainment and Chick-fil-A, this space enjoys outstanding visibility and parking. Adjacent attractions include the Apex Kid's Center, Apex Arcade, Apex Bowling Center, Bumper Car and Go Kart Racing Pavillion, Laser Tag and Mini Golf Center, Ropes Course and Sports Simulators, Planet Fitness, Goldfish Swim School, Altitude Trampoline Park, Spenga Fitness, Pit Stop Tavern, 110 Grill, Starbucks, Evviva Trattoria, Okami, Friendly's, Hot Table, Qdoba, Protein House, Fairfield Inn by Marriot, Hyatt Place and many more.

Apex Center of New England

Boston Post Road West | Marlborough, MA

Space 10A



Highlights

- 5,000 SF High Profile Retail
- Great visibility and parking
- Endcap next to Goldfish Swim School

Immediate proximity to Apex Kid's Center, Apex Arcade, Apex Bowling, Bumper Car and Go Kart Racing Pavillion, Laser Tag and Mini Golf Center, Ropes Course and Sports Simulators, Planet Fitness, Goldfish Swim School, Altitude Trampoline Park, Spenga Fitness, Pit Stop Tavern, 110 Grill, Starbucks, Evviva Trattoria, Okami, Friendly's, Hot Table, Qdoba, Protein House, Fairfield Inn by Marriot, Hyatt Place and many more.

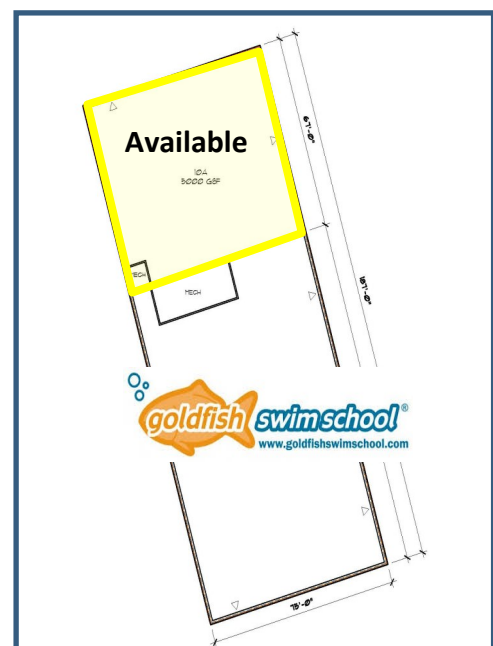

Apex Center of New England

Boston Post Road West | Marlborough, MA

Retail Market



2024 Demographics	1 Mile	3 Miles	5 Miles	10 Miles
Estimated Population	3,714	36,138	92,472	338,120
Estimated Daytime Population	11,527	33,106	69,755	181,996
Estimated Households	1,528	14,059	36,276	128,934
Estimated Average Household Income	\$129,34	\$125,180	\$130,368	\$143,420

Traffic Counts

Boston Post Road West	26,000+ ADT
I-495	120,000+ ADT

Boston Post Road West | Marlborough, MA

Site Plan



5,000 SF Available

Apex Center Master Site Plan

11-169 Apex Drive - Marlborough, MA

Contact Us



508-735-6378

dusty@acreco.com



508-735-5976

dusty3@acresco.com



508-397-7937

joe@acresco.com

50 Ledgeview Way #2415, Wrentham, Massachusetts 02093

Tel: (508) 735-6378 | E-mail: dusty@acreco.com | www.acreco.com